



EHS ANNUAL CONFERENCE 2022

EXHIBITOR PROSPECTUS

Clinical Applications in
Environmental Medicine

APRIL 8 – 10, 2022

LOEWS VENTANA CANYON RESORT

7000 NORTH RESORT DRIVE | TUCSON, AZ 85750

Clinical Applications in Environmental Medicine

The Environmental Health Symposium 2022 will address environmental exposures that cause disease in today's medical landscape

EHS 2022 Objectives:

- Understanding and treating Inflammation, toxicants and post viral syndrome
- Identifying and treating the issues related to vascular and thrombotic clotting potential
- Addressing the complex intersection of immune toxicant exposure, and the data that argues we can no longer assume people get sick due to a viral exposure alone.
- How toxicant exposure predisposes us to viral infection and where to begin to unravel the antecedents

What You'll Learn at EHS 2022:

- Evaluate disease through a toxicant exposure lens
- Critical information from case presentations (mold, metals, chronic infection)
- Understand toxicity, vascular damage, oxidative effects of ACE2 upregulation
- Address cellular damage and build immune resilience in children - our vulnerable population
- Solutions for EMF/EMR exposure that are backed by published science
- Genomics applied to environmental illness in today's medical landscape

+ About EHS



The annual Environmental Health Symposium conference provides physicians with an extraordinary opportunity to learn from internationally recognized experts and clinicians in Environmental Medicine. Speakers present emerging research that empower physicians to maximize successful patient outcomes.



Important for Clinicians:

- Inflammation has been shown to increase susceptibility to Covid19 and an underlying mechanism for many disease states, including obesity, insulin resistance and cardiometabolic disease
- Reversing inflammatory pathways that lead to cardiometabolic disease, obesity, insulin resistance, and autoimmunity is challenging and requires additional strategies; dietary changes alone are not enough
- Immune damage and vascular inflammation thrombotic effects of electromagnetic fields (EMF) have been evident in the medical literature for over 50 years and largely ignored by the medical community; an understanding of EMF exposure needs to become a standard part of patient education in the treatment plan
- Immune resilience strategies involve more than pills. Lifestyle modification strategies that include toxicant avoidance have to be included in patient treatment
- Medical providers need to understand how to evaluate patients for the negative effects of toxicant exposure, lectures will include patient handouts for practitioners to add to their clinical toolbox

Why Join Us?

- Environmental Medicine is a growing field
- Connect with the fastest growing community of expert practitioners in medicine today
- Intimate exhibit area with high attendee circulation
- Opportunities for in-depth conversations with attendees and faculty



EHS has grown steadily over the last 10 years and has gained recognition across the US and internationally as the leader in Environmental Medicine education. We are anticipating more than 300 highly informed and engaged medical and health professionals. This includes experts from around the world who make Environmental Medicine recommendations as part of their clinical practice.

Compared with other conferences of this caliber, EHS has an intimate exhibitor area with a limited number of exhibitor spaces. EHS offers exhibitors high attendee circulation and great exposure, along with ample opportunities for in-depth conversations with conference attendees and faculty.

Who Attends?

- MDs, NDs, DOs (90% of attendees are physicians)
- Healthcare practitioners such as NP, RN, LAc, RD, and CCN
- Physicians from functional medicine, integrative medicine and environmental medicine

Who Exhibits?



Clinical Diagnostic Laboratories



Compounding Pharmacies



Personal Care Products



Healthy Home + Workplace



Professional Opportunities



Medical Devices



Education



Nutraceuticals



Practice Management

EHS Years Past

- 2016** EHS Conference on Mycotoxins, Pesticides, and GMOs in San Diego, CA drew **400+ attendees**
- 2017** EHS Conference on Neuroinflammation, in San Diego, CA drew **300+ attendees**; 40% MDs and 60% NDs
- 2018** EHS Conference on Reducing Toxic Load, in Scottsdale, AZ drew **400+ attendees**; 50% MDs and 50% NDs
- 2019** EHS Conference on Endocrine Disruption in Scottsdale, AZ drew **400+ attendees**; 50% MDs and 50% NDs
- 2020** EHS Online Conference on Immunotoxicity drew over **600 attendees**; 50% MDs and 50% NDs
- 2021** EHS Online Conference on Toxic Metals Effects drew over **400 attendees**; 50% MDs and 50% NDs

Highlights

- 300+ attendees expected
- 38 standard exhibitor booths
- 12 premier exhibitor booths
- Loews Ventana named one of the 10 Best luxury hotels in Tucson by USA Today
- Sponsored Lunch & Evening
- Speaking Opportunities
- Sponsored Presentations in main Lecture Hall

Conference Activities:

In addition to 3 days of rich content, there are a number of special events during the conference offering additional opportunities for exhibitors to have direct contact with health professionals, attendees, and thought leaders throughout the conference. One highlight is the Friday evening Exhibitor Reception.

- For a full agenda and conference schedule, please visit the EHS website at EHS2022.com or EnvironmentalHealthSymposium.com for the most up-to-date information.

Booth Opportunities

Regular 8x10 Booth Space	\$2,800
Corner 8x10 Booth Space	\$3,100
Premium 10x10 Booth Space	\$3,700

Included With Your Exhibit Booth Space

- 6' skirted table in an 8'x10' or 10'x10' space, pipe & drape, white table linen, carpet, two chairs, wastebasket, ID signage, Internet access, attend educational sessions and complimentary listing in conference program.
- Booth includes access for two (2) company representatives to staff your exhibit booth.
- Additional booth staff registrations available for \$250 per person, up to a maximum of four (4) total sales representatives per booth. There is an additional charge of \$200 for exhibitors to receive CE/CME credits that must be registered and paid for in advance.

Not Included With Your Exhibit Booth Space

Electricity, additional furniture or equipment rentals, labor for installing or dismantling your exhibit display. The exhibit management company will provide an exhibitor service kit with order forms for all additional options. Service Kit will be sent to exhibitors in January 2022.

Lunch and evening Sponsored Presentations are limited to registered conference attendees only.

Loews Ventana Canyon Resort

7000 North Resort Drive
Tucson, AZ 85750

Resort Reservations:
877.879.9979 or 520.299.2020
Use Group Code "EHS"

EHS Room Block available until March 21, 2022 Discounted rate is \$219 a night for single/double

EHS has reserved a block of rooms with special discounts only to those booking through the group negotiated rate

Special Rate Includes:

- Complimentary Self-parking
- Waived Resort Fee (normally \$29)
- Complimentary Wi-Fi in Guest Rooms

Registration Link:

loewshotels.com/ventana-canyon/environmental-health-symposium

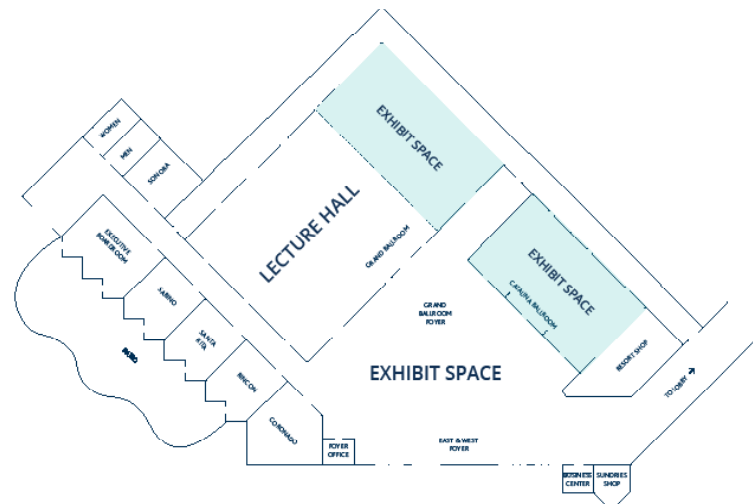

Exhibit area is in the Conference foyer and adjoining ballrooms. Booth allocations will be first come, first serve.

- To Purchase a Booth, for Additional Information or Questions, Contact Us At:

email: info@environmentalhealthsymposium.com
call: 855-347-4477

- Exhibitor & Sponsorship Opportunities

email: Cheryl@environmentalhealthsymposium.com
call: 303-875-8658

Exhibitor Eligibility

The Exhibit space at EHS 2022 is designed for the display and demonstration of products and/or services directly related to the practice, science, and advancement of Environmental Medicine. EHS has the sole authority to determine eligibility of any company and/or its product. EHS reserves the right to refuse applications of organizations that do not meet EHS conference standard requirements or expectations. EHS reserves the right to close exhibits that reflect unfavorably on the character and the purpose of the conference. This pertains to displays, literature, advertising, novelties, and conduct.

Exhibitor Vetting Policy

EHS strives to have an Exhibit Hall that provides the best experience for both vendors and attendees. We only support the presentation and sales of goods and services that have demonstrated clinical relevance, clinical efficacy and safety.

The organizers of EHS have identified the following which do not meet EHS criteria and therefore EHS does not support their presentation or sales at the conference. We ask that if you are exhibiting at EHS that the following products be omitted from your display. If these are your primary products, we feel that you would not be a good fit for our conference.

The following are “Detox products” that do not have adequate scientific substantiation or have been shown to have no efficacy for their stated purpose:

- Detox foot baths
- Chlorella or Cilantro (in any form) for metal removal
- Modified citrus pectin for metal removal
- Zeolite
- Oral, liposomal EDTA
- Transdermal EDTA, DMSA or DMPS
- Unapproved Laboratory testing
 - Dipstick urine testing for total toxic metal presence
- Air Purification
 - Ozone
 - Ion generation

If new clinical data is published in peer-reviewed PubMed indexed journals on any of the above between the time of this writing and your application for the Exhibitor Hall please provide it to us along with the product you wish to present.

Continuing Medical Education Guidelines

All exhibitors must be in a room or area separate from the education and the exhibits must not interfere or in any way compete with the learning experience prior to, during, or immediately after the activity. All promotional activities including interviews, demonstrations, and the distribution of literature or samples must be made within the exhibitor’s rented exhibit area. Canvassing or distributing promotional materials outside the exhibitor’s rented exhibit space is not permitted.



EHS Underwriter Criteria

EHS takes special measures to expose our attendees to leaders in the field of Environmental Medicine with high quality products, laboratory testing, and dietary supplements.

Exhibitor Management

The exhibit management company and information related to shipping & receiving will be available January 2022.

“EHS is the best conference to obtain cutting-edge information on environmental toxic burden, an under-recognized crisis in medicine that is often overlooked and is threatening all of our patients’ health.”

Dr Jill Carnahan, MD

Security

At your own risk, no security guard will be present. Neither the Hotel nor EHS will accept liability for any items left in the Exhibit Area.

Cancellation Policy

Cancellations by an exhibitor must be given in writing either by email or postal mail, to be effective.

Written cancellation request mail to:

Environmental Health Symposium
PO Box 6364, Broomfield, CO 80021

Email cancellation request to:

Cheryl@EnvironmentalHealthSymposium.com

The terms and conditions for cancellation are set forth in the conditions, rules and regulations attached hereto below and incorporated herein. Exhibitors cancelling on or before February 1, 2022 shall be subject to a cancellation fee equal to 50% of the total cost of cancelled space. Cancellations occurring after February 1, 2022 are subject to a cancellation fee equal to 100% of the total cost of cancelled space. All outstanding cancellation fees are payable immediately upon cancellation.

Health and Safety

The health and safety of our exhibitors, attendees, sponsors, speakers and staff is our top priority as we plan the Environmental Health Symposium in-person 2022 event.

We will continue to monitor the COVID-19 pandemic. We are in close collaboration with our conference hotel (Loews Ventana Canyon Resort) and will continue to review local and state recommendations to make sure EHS is following all recommended guidelines. Our protocols will reflect the most current advice and best practices.



Exhibitor Setup Times

Setup: Thursday, April 7, 2022

4:00pm - 8:00 pm

Teardown: Sunday April 10, 2022

2:00pm - 5:00 pm

Exhibitor Schedule

Friday April 8, 2022

8:00am – 7:30pm	Exhibits Open
10:30am – 11:30am	Exhibitor Break
1:30pm – 2:30pm	Lunch/ Exhibitor Break
4:00pm – 4:30pm	Exhibitor Break
5:30 – 6:30pm	Exhibitor Sponsored Presentations
6:30 – 7:30pm	Exhibitor Reception/Wine Tasting/Music

Saturday April 9, 2022

8:00am – 7:00pm	Exhibits Open
10:30am – 11:30am	Exhibitor Break
1:00pm – 2:00pm	Lunch/ Exhibitor Break
4:00 – 5:00pm	Exhibitor Break
6:00 – 7:00pm	Exhibitor Sponsored Presentations

Sunday April 10, 2022

8:00am – 4:00pm	Exhibits Open
10:30am – 11:30am	Exhibitor Break
1:00pm – 2:00pm	Lunch/Exhibitor Break
4:00pm	Conference ends

Important Deadlines

- Exhibitor Booth Sales and Attendee Registration Opens **9/1/2021**
- Upon Registration - All Exhibitor Materials are due upon registration (Company Logo & Company Description)
- Exhibitor Service Kit Distributed **1/15/2022**
- Ads due for E-Program and/or Graphics due for Signage **3/11/2022**
- Last day for EHS room block special rates **3/29/2022**
- Literature and Product Bag Inserts to be received at hotel **4/1/2022**



Exhibitor Policies & Procedures

- 1. Purpose** The purpose of the exhibition portion of the Environmental Health Symposium is to complement the continuing education sessions and to inform and educate attendees on the latest developments in environmental medicine related technologies, products, services and equipment.
- 2. Terms** The term EHS used herein shall refer to the Environmental Health Symposium and, as the context may require, its employees or agents, duly acting for the EHS in the management of the conference and exhibition.
- 3. Eligibility & Criteria** The EHS reserves the right to deny any application and or remove exhibitors from the exhibit hall at its sole and arbitrary discretion. Criteria for exhibitors includes (but is not limited to): (1) relevancy to the profession and the mission of the EHS, (2) stated claims must be true and supported by published materials, and (3) professional and ethical conduct required at all times by the exhibitor and its staff.
- 4. Exhibit Space Rental** Please refer to the Exhibitor Application for rates, payment terms, and inclusions. Exhibitor is solely responsible (and indemnifies the EHS) for all expenses related to participation in the conference including: travel, lodging, food, shipping costs, booth furniture and supplies, etc. Each booth includes two conference registration. Exhibitor understands that there is a **MANDATORY** fee of \$250 per person for each additional staff badge above the 2 staff badges provided. Please see paragraph 10 for more information.
- 5. Exhibit Space Specifications** All individual booths are 8'x10' and/ or 10'x10'and cannot be subdivided into smaller booth spaces. The back wall or any construction in linear booth shall not exceed eight feet (8') in height including: signs, company name/logo or product information. All display material is restricted to a maximum height of four feet (4') in the front half of the booth and a maximum of eight feet (8') in the back half. NO end caps are available. Multiple booths must be purchased in a linear row. Exhibitors may be asked to alter or remove any portion of their booth that is found to be questionable or impedes a neighboring exhibitor.
- 6. Space Assignments** Exhibit space will be allotted on a first-come, first-serve basis. Sponsors, however, will receive priority choice of any premium spots. For more information on sponsorship, contact Cheryl Gray at 303-875-8658.
- 7. Floor Plan/Layout** The EHS reserves the right to modify the existing floor plan to accommodate space sales, to avoid conflicts or to comply with local ordinances.
- 8. Cancellations & Reductions** Once the contract is signed and exhibit space is allocated, you are contracted for exhibit space. Cancellations must be made in writing and will incur a cancellation fee as laid out herein. (1) Cancellations and booth downsize requests received by 02/01/2022 are subject to a cancellation fee equal to 50% of the booth space. (2) Cancellations and booth downsize requests received on/after 02/01/2022 are not eligible for a refund of any kind.
- 9. Subletting Booth** Space Exhibitors may not sublet booth space under any circumstances. Booths may be shared, however, only ONE contact person per booth is permitted. Sharing requests must be made at the time of application, EHS reserves the right to review credentials and claims of all parties.
- 10. Booth Staffing/Badges** Booths must be staffed by qualified employees of the exhibiting company during show hours. Each booth will receive two (2) conference registrations, which include admittance to all educational sessions and conference activities. CE/CME credits can be purchased for an additional \$200 for each booth attendee requesting them. Two (2) additional staff badges may be purchased for \$250 each, up to a total of (4) staff attending for each exhibitor booth rental.
- 11. Booth Appearance & Noise** All exhibits will be inspected during setup to ensure all booths are decorated in good taste, safely secured and professionally designed. Noise from electrical or mechanical apparatus or other types of displays that causes interference or annoyance to other exhibitors must be discontinued.
- 12. Children** NO Children under the age of 16 are allowed in the Exhibit Hall.
- 13. Americans with Disabilities Act** Each exhibitor shall be responsible for compliance with all applicable provisions of the ADA within its booth and exhibit space including but not limited to wheelchair access. Exhibitors shall indemnify, hold harmless and defend the EHS from and against any claims, liabilities, losses, damages and expenses (including attorney's fees and expenses) resulting from or arising out of the exhibitor's failure (or allegation of failure) to comply with the provisions of the ADA.
- 14. Over the Counter Sales** Exhibitors are encouraged to offer information that is educational, professional, and instructional. Exhibitors may take orders for product sales. It is the responsibility of the exhibitor to contact local authorities for information regarding sales tax or other local laws and regulations.
- 15. Media-related Activities** All public relations, press & media-related activities must be approved by the EHS.
- 16. Printed Materials/Signage** Distribution of promotional materials printed by exhibitors or their agents is limited to the exhibit area rented by the exhibitor. Materials displayed in other areas may be removed.
- 17. Advertising / Public Relations** Third parties such as advertising/ public relations agencies acting on behalf of the exhibitors must also abide by all rules and regulations related to the EHS 2022 conference. It is the responsibility of the exhibitor to make all parties aware of all rules & guidelines.
- 18. Sponsored Functions** Social & hospitality functions conducted by the Exhibitor must be in a manner that is consistent with the professional and educational nature of the EHS 2022 conference. All planned functions must be approved by the EHS Meetings Department in writing.
- 19. Promotions & Giveaways** All printed promotions directly related to onsite activities must be approved by the EHS at least four (4) weeks prior to the event. No adhesive or noisy promotional materials are permitted under any circumstance. All drawings, raffles, lotteries and contests must be submitted to and approved by EHS. Exhibitor must abide by hotel policy for all food & beverage giveaways.
- 20. Door Drops** A sponsorship opportunity, door drops must be arranged through the EHS Meetings Department. Contact EHS for additional information.
- 21. Security** The EHS, security vendor, and conference venue will not be held responsible for the safety of the property of the exhibitors from theft, damage by fire, accident, vandalism or other causes. The EHS strongly recommends that exhibiting companies secure a rider to cover all booth and display items during transportation to, during and from this event. EHS insurance policies do not extend to exhibitor liabilities.
- 22. Indemnity** The Exhibitor agrees to indemnify and hold the EHS, its employees, agents, officials and contractors and the conference venues harmless against any and all damages, claims, judgments, losses, costs and expenses (including attorney fees) that may be incurred, suffered, sustained by or imposed upon the EHS and/or the conference venue by reason of exhibitor's activities pursuant to the approved exhibit space application and contract. This indemnification agreement includes but is not limited to all claims, damages, losses or expenses attributable to personal or bodily injury, sickness, disease or death, or injury to or destruction of tangible property, including the loss of such property.
- 23. Compliance with Local Ordinances** License and permit required by local statute, ordinance or regulations are to be obtained by and paid for by the exhibitor. Each exhibitor will be responsible for compliance with local health, fire and safety ordinances and regulations. The EHS strongly suggests that any company serving food or beverage samples contact local health departments to ensure compliance with local laws and ordinances. All materials used for the building, decorating, draping or covering of booths and/or stands must be non-flammable, or rendered so by being immersed in a fire-proofing solution. All exhibits are subject to inspection by the public safety authorities having jurisdiction over the Conference facility and Exhibitor agrees to comply with the directions of said authorities on all matters.
- 24. Damage to Facilities** Exhibitor must surrender space occupied/ rented in the same condition as the time of occupation. Exhibitors will be responsible for any damage done to the facilities and for any and all claims and demands on account of any injury, death or damage done to property occurring in or upon exhibitor's booth space or due to exhibitor's acts. No nails, tacks or screws may be driven into the floor, wall or woodwork of the building.